

INSTRUCCIONES DE SEGURIDAD

Luminaria únicamente de uso doméstico y de interior.
 Las conexiones eléctricas deben realizarse por personal especializado.
 Antes de empezar las operaciones de montaje:
 Deje sin tensión eléctrica la red.
 Extraiga el fusible o deje el interruptor en posición de "desconectado".
 Utilice siempre la bombilla recomendada.
 Bombilla incandescente tubular Máx. 18 x 60W E27.
 Bombilla fluerescencia compacta Max. 18 x 23W TCT-SE E27.
 Conexión tipo X: Si el cable flexible o cordón de esta luminaria está dañado, debe sustituirse por un cable flexible o cordón especial que suministre exclusivamente el fabricante o su servicio técnico.
 Antes de sustituir la bombilla, asegúrese de desconectar la luminaria de la red, y esperar que esté fría al tacto.
 El fabricante no se hace responsable del uso indebido de la luminaria.

SAFETY INSTRUCTIONS

The lamp is for domestic interior use only.
 The lamp must be installed by a specialist.
 Before connecting the lamp:
 Be sure that there is no voltage in the power line.
 Remove the fuse or leave the switch in disconnected position.
 Always use the recommended bulb.
 Tubular incandescent Max. 18 x 60W E27 in Europe or E26 in USA.
 Compact fluorescent Max. 18 x 23W TCT-SE E27 in Europe or E26 in USA.
 Connection X Type: If the cable or cord of this lamp is damaged, it must be replaced with a flexible cable or special cord that gives exclusively the manufacturer or the technical service.
 Before replacing the bulb, switch off the main electrical switch and wait until the bulb has cooled down.
 The manufacturer declines all responsibility for misuse of the lamp.

Características Técnicas / Technical characteristics:

EUROPE	AC 230V	50 Hz
USA/JAPAN	AC 110/128V	60 Hz



07/2008



SANTA & COLE

MONTECARLO

Lámpara de suspensión 3 soportes
 3 supports hanging lamp

DORIS SEWCZYK

INSTRUCCIONES DE MONTAJE

ASSEMBLY INSTRUCTIONS

1

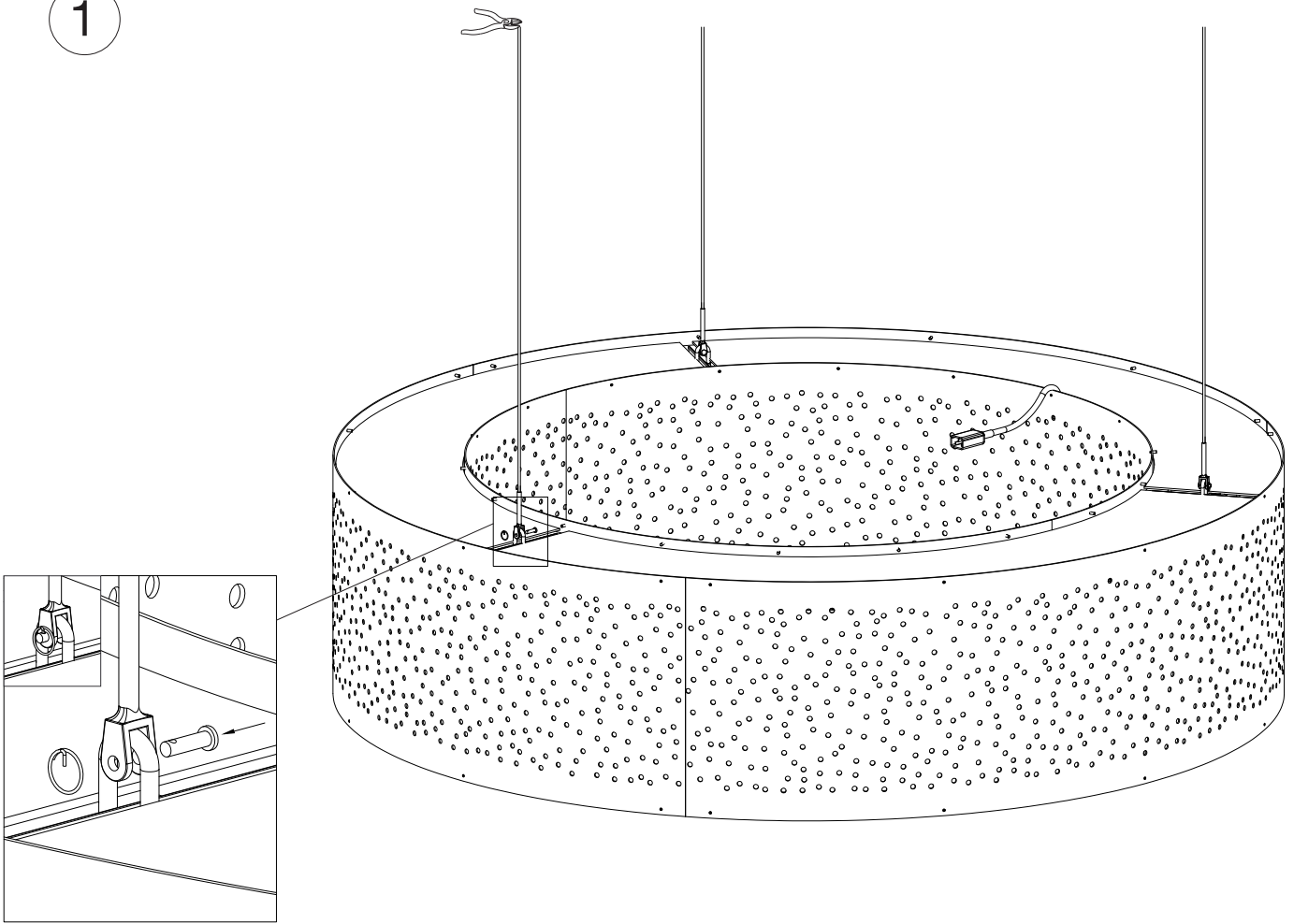

2

Situación de los taladros y posicionamiento de los florones.
Drill's situation and canopy's position.

A Recomendaciones para el taladrado en hormigón:

- Broca de Ø10 mm.
- Profundidad mínima de 60mm.

Recommendations to make drill's in concrete:

- Bit of Ø10 mm.
- Minimun depth: 60 mm.

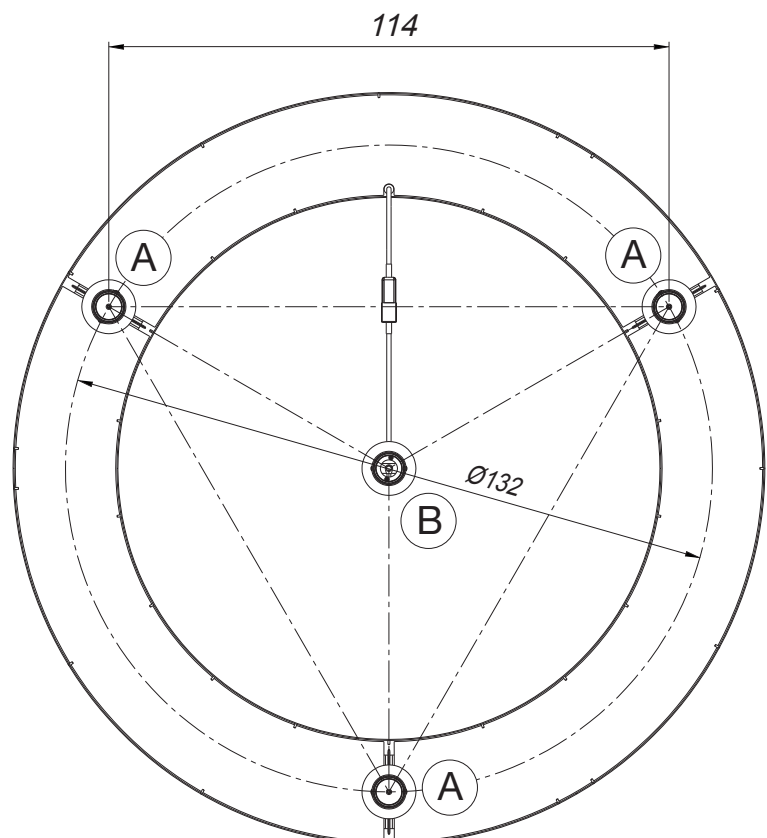

A

Ø10 mm.

3

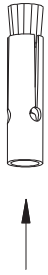

4

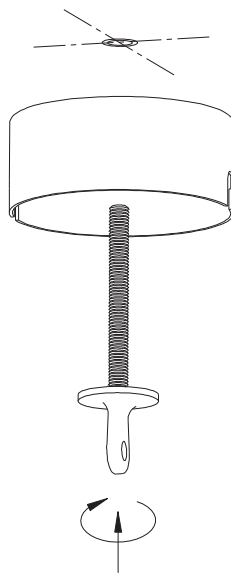

5

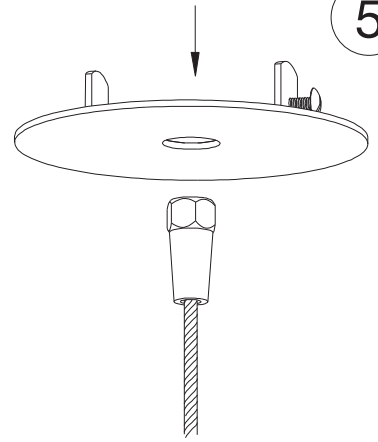

6

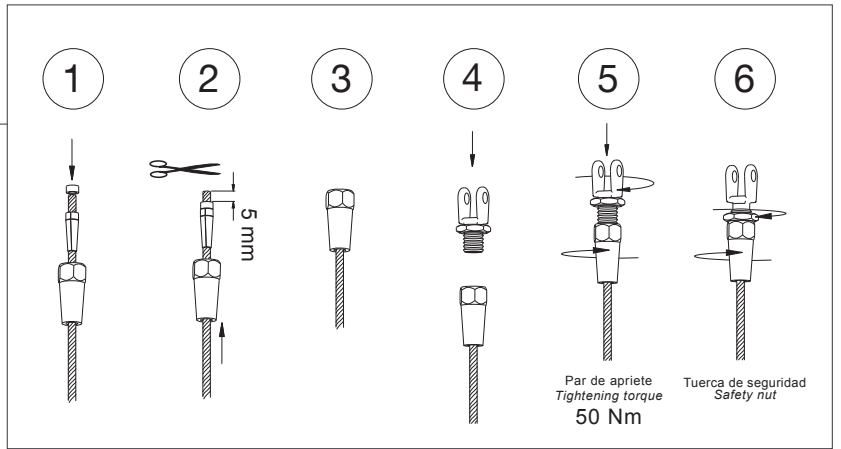
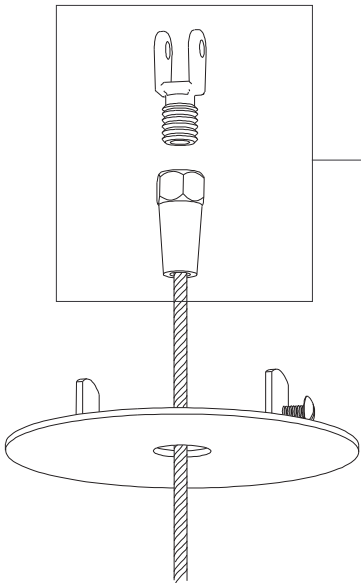

7

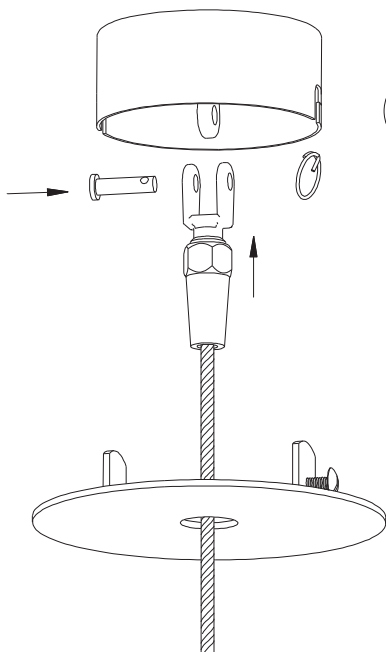

8

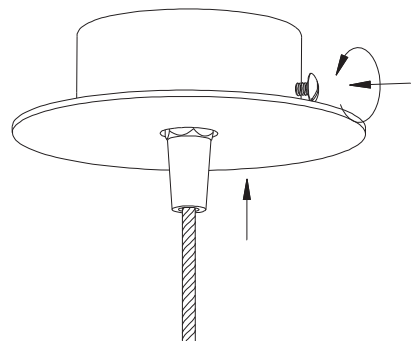

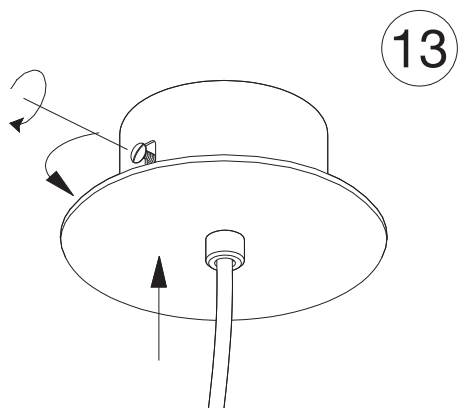
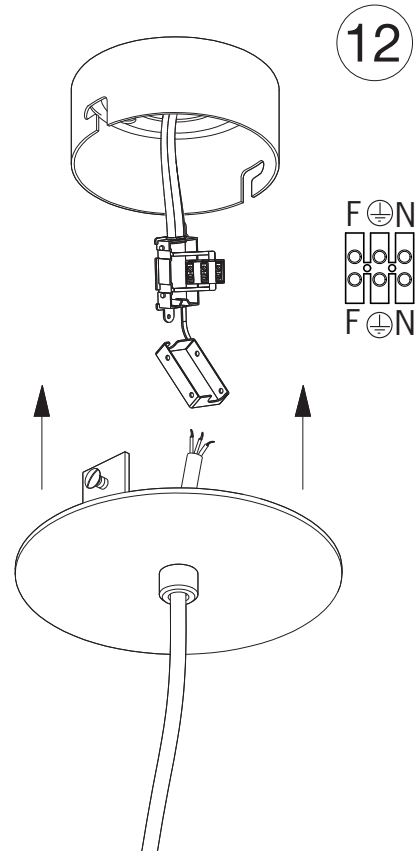
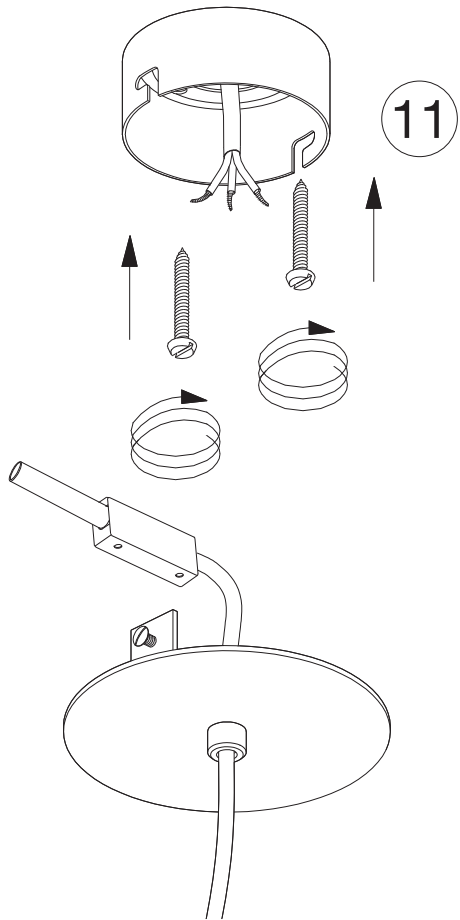
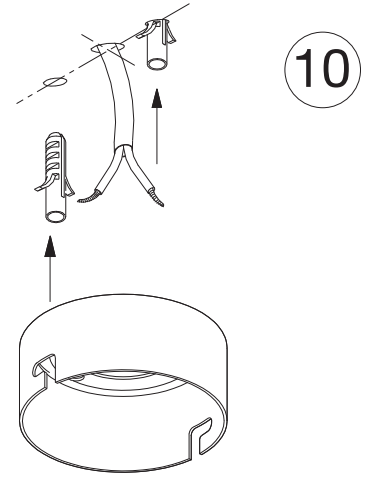
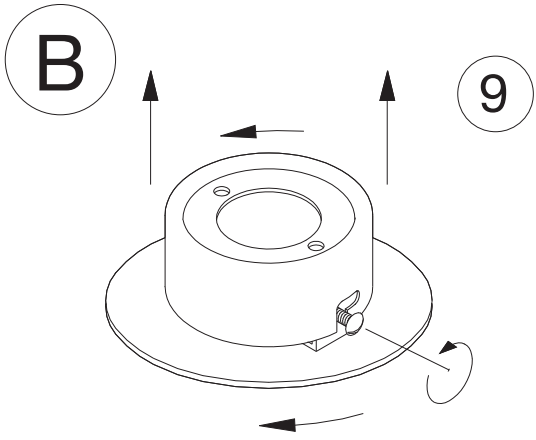

14

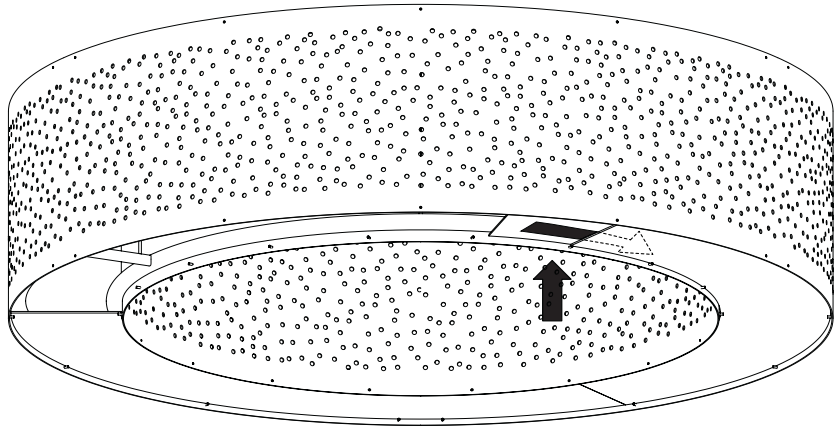

15

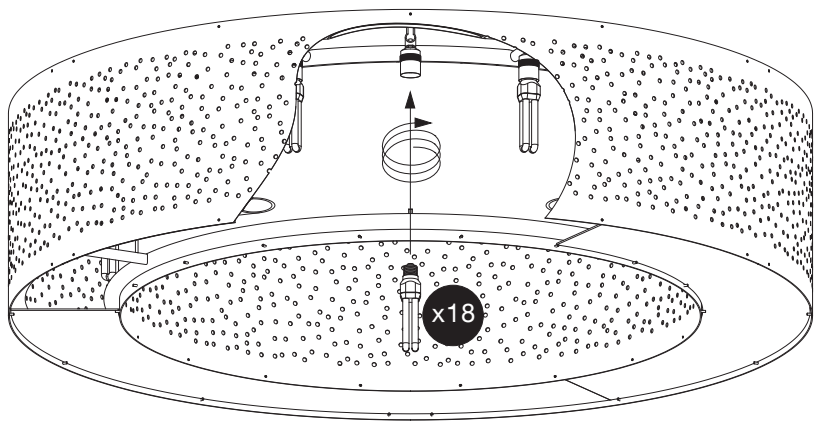

16

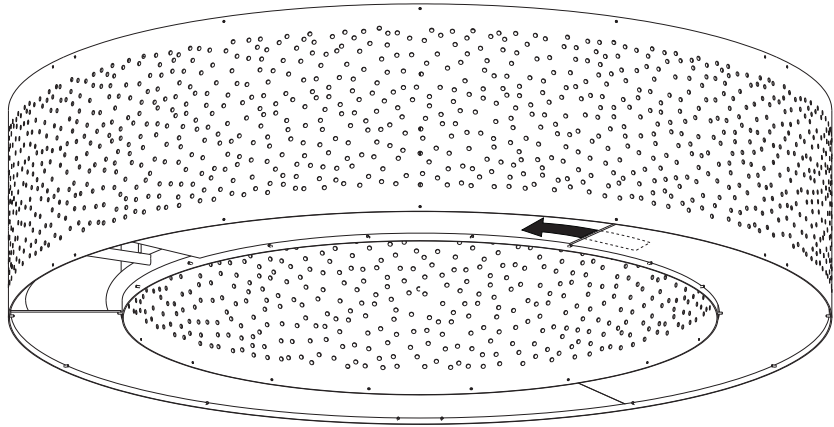

18 BOMBILLAS/BULBS 60W 230V = 1080W
18 BOMBILLAS TC-TSE/TC-TSE BULBS 23W 230V = 414W

Peso total aprox.
150 kg